

New Key #s on Olympus Cabinet Drawer Locks - 200-26D158
from Page 614 MP Catalog

OLYMPUS CABINET DRAWER LOCK
For Commercial Drawers

**Cabinet Drawer
Rekeyable
Deadbolt Lock**



200DW

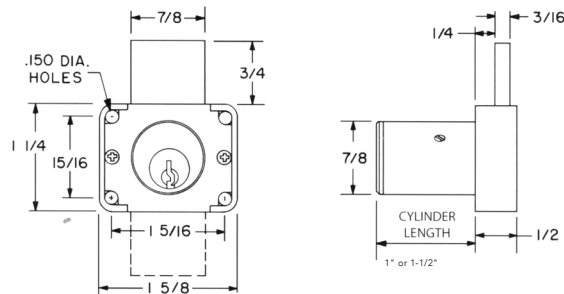

Schlage "C" keyway. Re-keyable pin tumbler lock.
Pinned for 5, drilled for 6. Satin chrome (26D) finish.
Stocked keyed alike or different.

Material Thickness: 7/8", 1-3/8", or 1-5/8"

Code	Key #	Mat. Thknss	Ctn	List/ea
200-26D78-	XXXXX	7/8"	10 ea.	\$ 29.47
200-26D138-	XXXXX	1-3/8"	10	29.47
200-26D158-	XXXXX	1-5/8"	10	32.51

Available Key Numbers:

7/8" = 107, 915, G0001, G0002, G0003, G0004,
G0005, KD (Keyed Different)

1-3/8" = 107, 915, G0001 thru G0009, KD*

1-5/8" = G0001, G0002, **G0003, G0004, G0005,**
G0006, G0007, KD*

* KD/MK